

KEY PLAN

| | | |
|-----------|---------|---------|
| NOTED BY: | Francis | 1/17/18 |
| | RMS | 1/17/18 |
| | AMC | 1/17/18 |



FLORES
LOWER LEVEL 2 FLOOR PLAN
 OCTOBER 2018
 PER MEMO REF. DE-18-10-008

NOTE:
 Standard company policy regarding request for tandem shall apply.

ivory wood
IVORY WOOD

Disclaimer: Floor plans depicted in this material are for demonstration purposes only and should not be relied upon as final project plans. For announcement purposes only.

AVAILABILITY PLAN

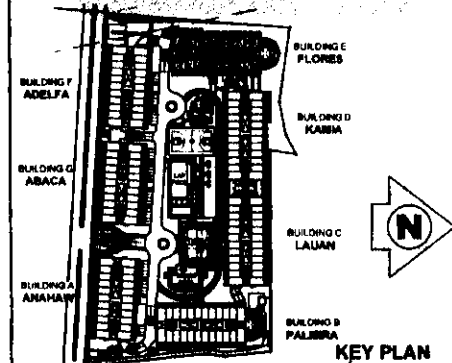
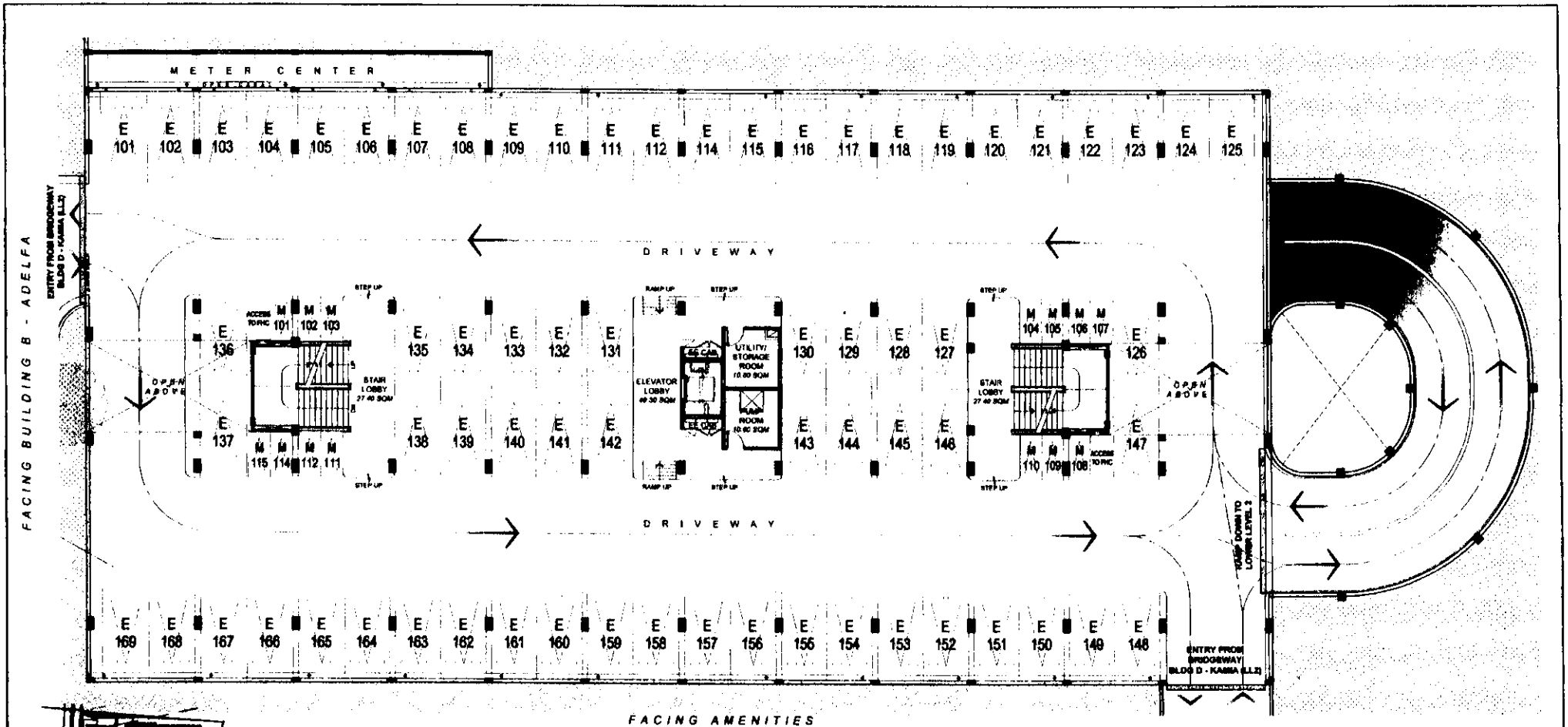

FLORES
 LOWER LEVEL 1 FLOOR PLAN
 OCTOBER 2018
 PER MEMO REF. DE-18-10-008

NOTE:
 Standard company policy regarding request for tandem shall apply.

iw
 IVORY WOOD

| | | | |
|--|-----------|---------|----------|
| | NOTED BY: | Francis | 10/15/18 |
| | | RMS | 10/17/18 |
| | | AMC | 10/14/18 |

Disclaimer: Floor plans depicted in this material are for demonstration purposes only and should not be relied upon as final project plans. For announcement purposes only.

AVAILABILITY PLAN

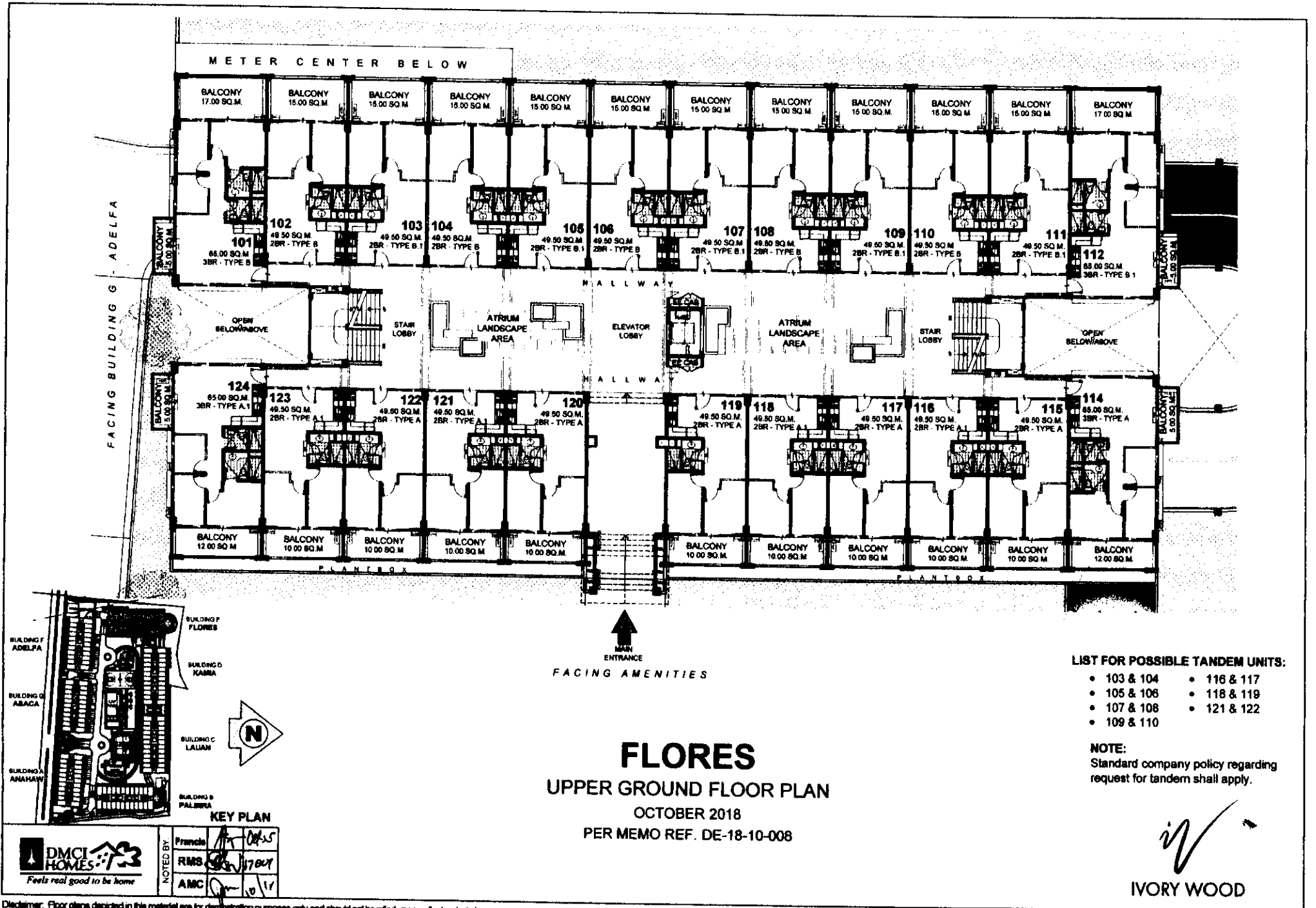

Disclaimer: Floor plans depicted in this material are for demonstration purposes only and should not be relied upon as final project plans. For announcement purposes only.

AVAILABILITY PLAN

FACING BUILDING G - ADELFA

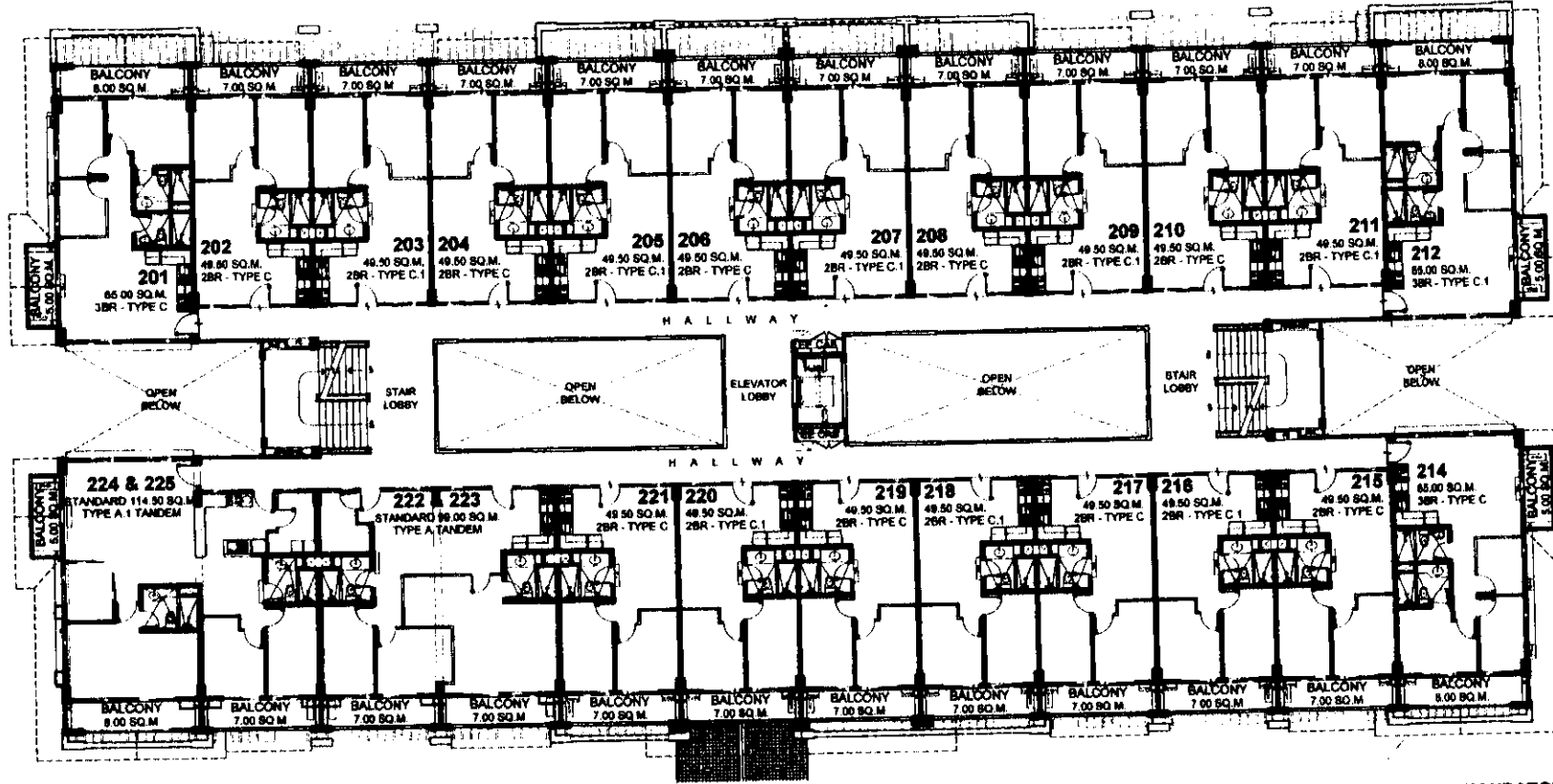

FACING AMENITIES

LIST FOR MANDATORY TANDEM UNITS:

- 222 & 223
- 224 & 225

LIST FOR POSSIBLE TANDEM UNITS:

- 203 & 204
- 205 & 206
- 207 & 208
- 209 & 210
- 216 & 217
- 218 & 219
- 220 & 221

NOTE:
Standard company policy regarding request for tandem shall apply.

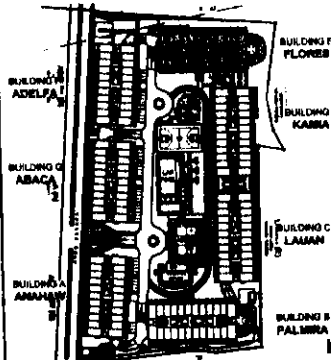

KEY PLAN

| | | |
|-----------|---------|--------|
| NOTED BY: | Francis | 10/15 |
| | RMS | 17 Oct |
| | AMC | 10/15 |



FLORES
SECOND FLOOR PLAN
OCTOBER 2018
PER MEMO REF. DE-18-10-008

iw
IVORY WOOD

AVAILABILITY PLAN

Disclaimer: Floor plans depicted in this material are for dissemination purposes only and should not be relied upon as final project plans. For announcement purposes only.

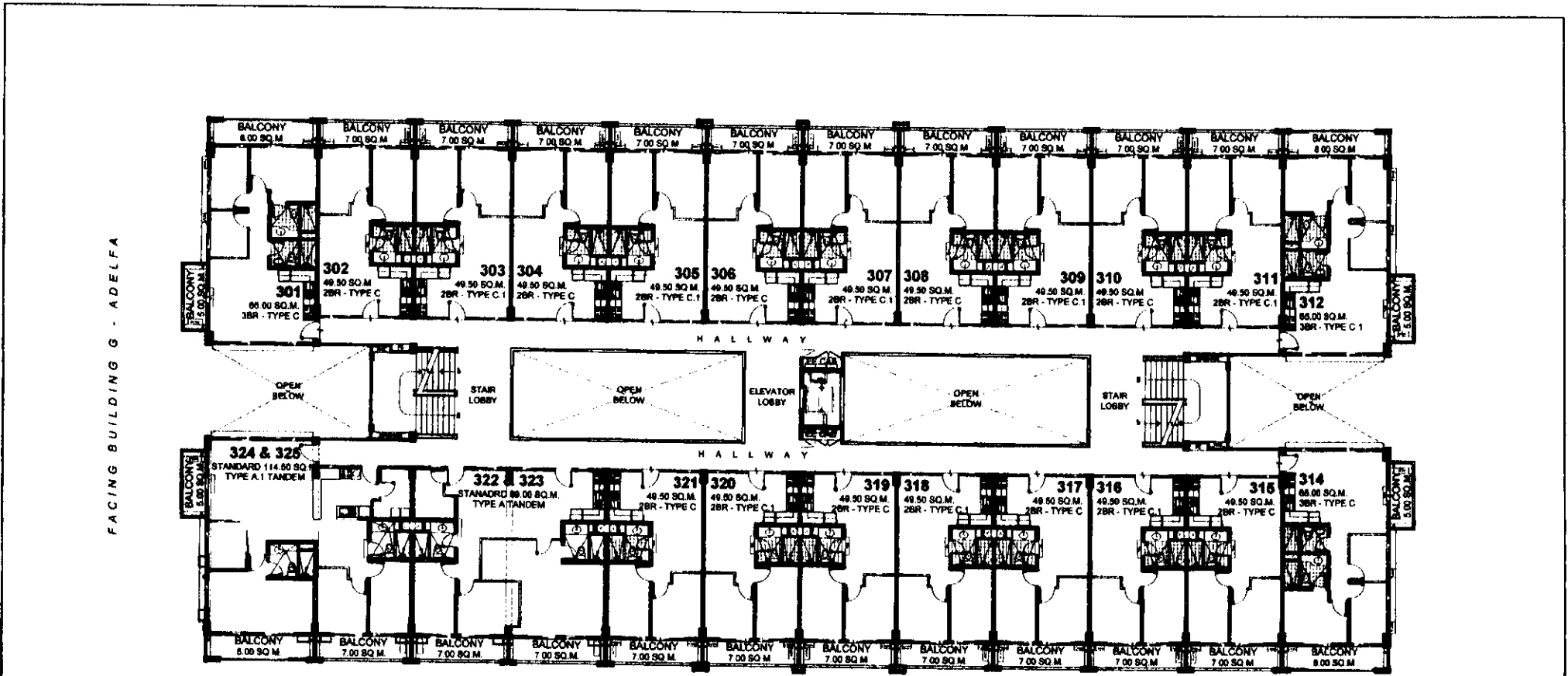

FACING BUILDING G - ADELFA

FACING AMENITIES

LIST FOR MANDATORY TANDEM UNITS:

- 322 & 323
- 324 & 325

LIST FOR POSSIBLE TANDEM UNITS:

- 303 & 304
- 305 & 308
- 307 & 308
- 309 & 310
- 316 & 317
- 318 & 319
- 320 & 321

NOTE:
Standard company policy regarding request for tandem shall apply.

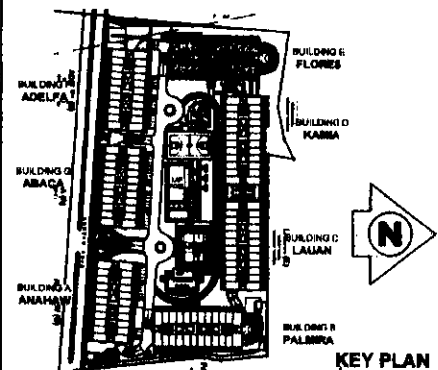

KEY PLAN

| | | | |
|--|----------|---------|-------|
| <p>DMCI HOMES Feels real good to be home</p> | NOTED BY | Francis | 08/15 |
| | | RMS | 17/07 |
| | | AMC | 10/14 |

FLORES
THIRD FLOOR PLAN
OCTOBER 2018
PER MEMO REF. DE-18-10-008

(Signature)
IVORY WOOD

Disclaimer: Floor plans depicted in this material are for demonstration purposes only and should not be relied upon as final project plans. For announcement purposes only.

AVAILABILITY PLAN

FACING BUILDING G - ADELFA

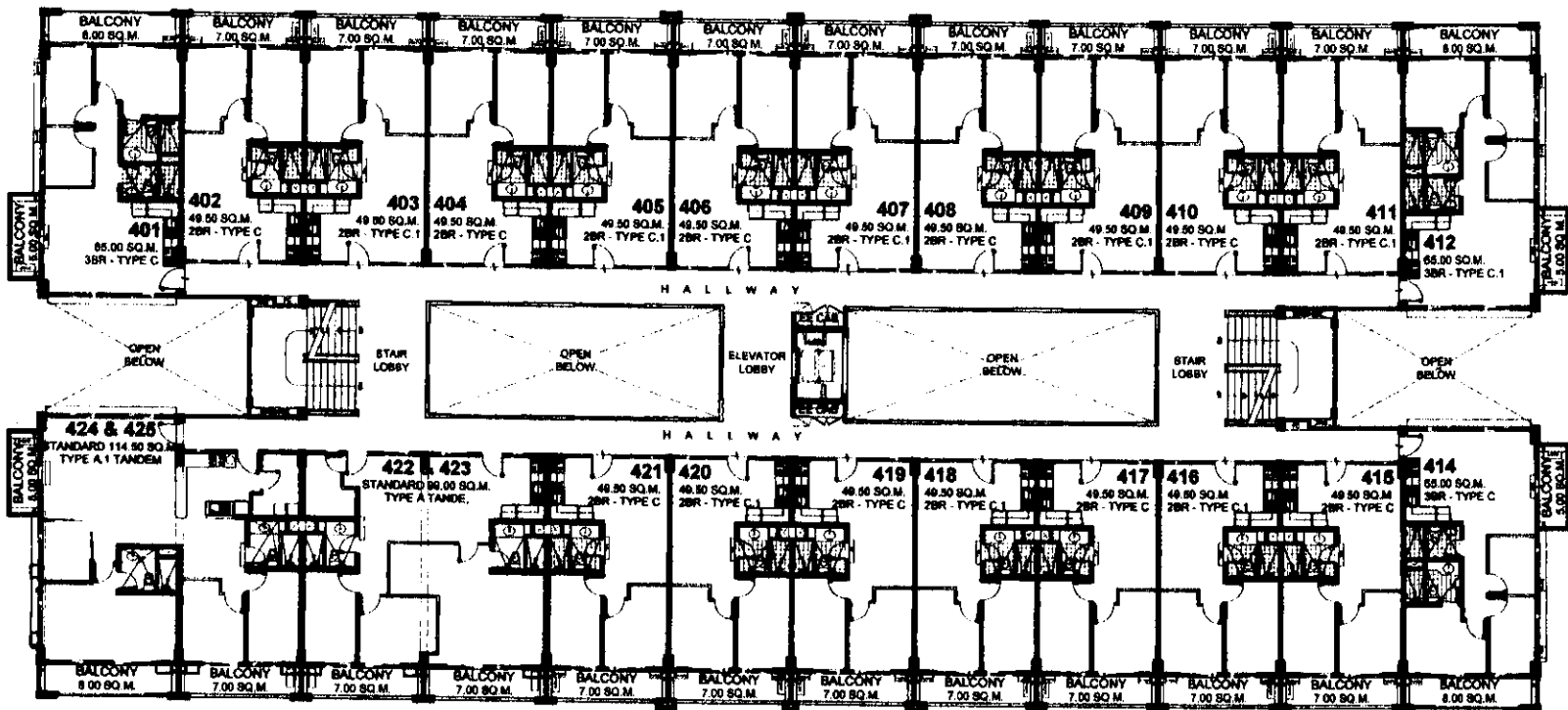

FACING AMENITIES

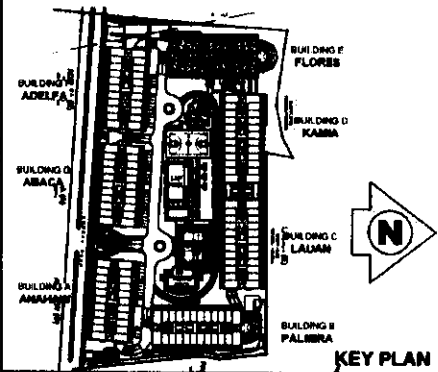

FLORES
FOURTH FLOOR PLAN
 OCTOBER 2018
 PER MEMO REF. DE-18-10-008

LIST FOR MANDATORY TANDEM UNITS:

- 422 & 423
- 424 & 425

LIST FOR POSSIBLE TANDEM UNITS:

- 403 & 404
- 405 & 406
- 407 & 408
- 409 & 410
- 416 & 417
- 418 & 419
- 420 & 421

NOTE:
 Standard company policy regarding request for tandem shall apply.

(Signature)
IVORY WOOD

| | | | |
|--|-----------|---------|------|
| <p>DMCI HOMES Feels real good to be home</p> | NOTED BY: | Francis | 04-5 |
| | | RMS | 1702 |
| | | AMC | 10/4 |

Disclaimer: Floor plans depicted in this material are for demonstration purposes only and should not be relied upon as final project plans. For announcement purposes only.

AVAILABILITY PLAN

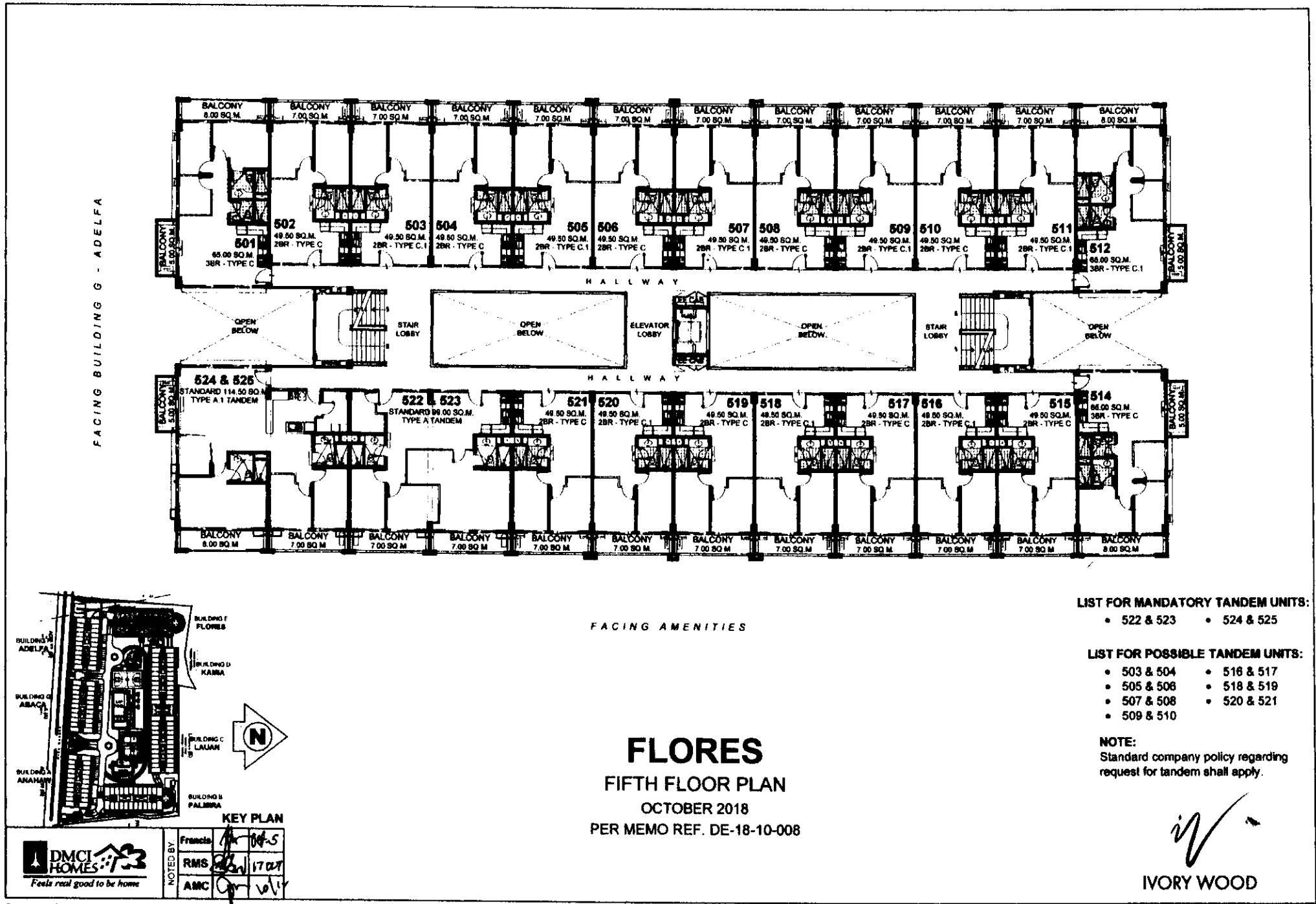

FACING BUILDING G - ADELFA

FACING AMENITIES

FLORES
FIFTH FLOOR PLAN
 OCTOBER 2018
 PER MEMO REF. DE-18-10-008

LIST FOR MANDATORY TANDEM UNITS:
 • 522 & 523 • 524 & 525

LIST FOR POSSIBLE TANDEM UNITS:
 • 503 & 504 • 516 & 517
 • 505 & 506 • 518 & 519
 • 507 & 508 • 520 & 521
 • 509 & 510

NOTE:
 Standard company policy regarding request for tandem shall apply.

iw
IVORY WOOD

KEY PLAN

BUILDING F FLORES
 BUILDING D KAIMA
 BUILDING C LALAM
 BUILDING B PALMIRA
 BUILDING E ABACA
 BUILDING A ANAHAPA

NOTED BY: Francisco [Signature] 10/15
 RMS [Signature] 10/17
 AMC [Signature] 10/17

DMCI HOMES
 Feels real good to be home

Disclaimer: Floor plans depicted in this material are for demonstration purposes only and should not be relied upon as final project plans. For announcement purposes only.

FACING BUILDING G - ADELFA

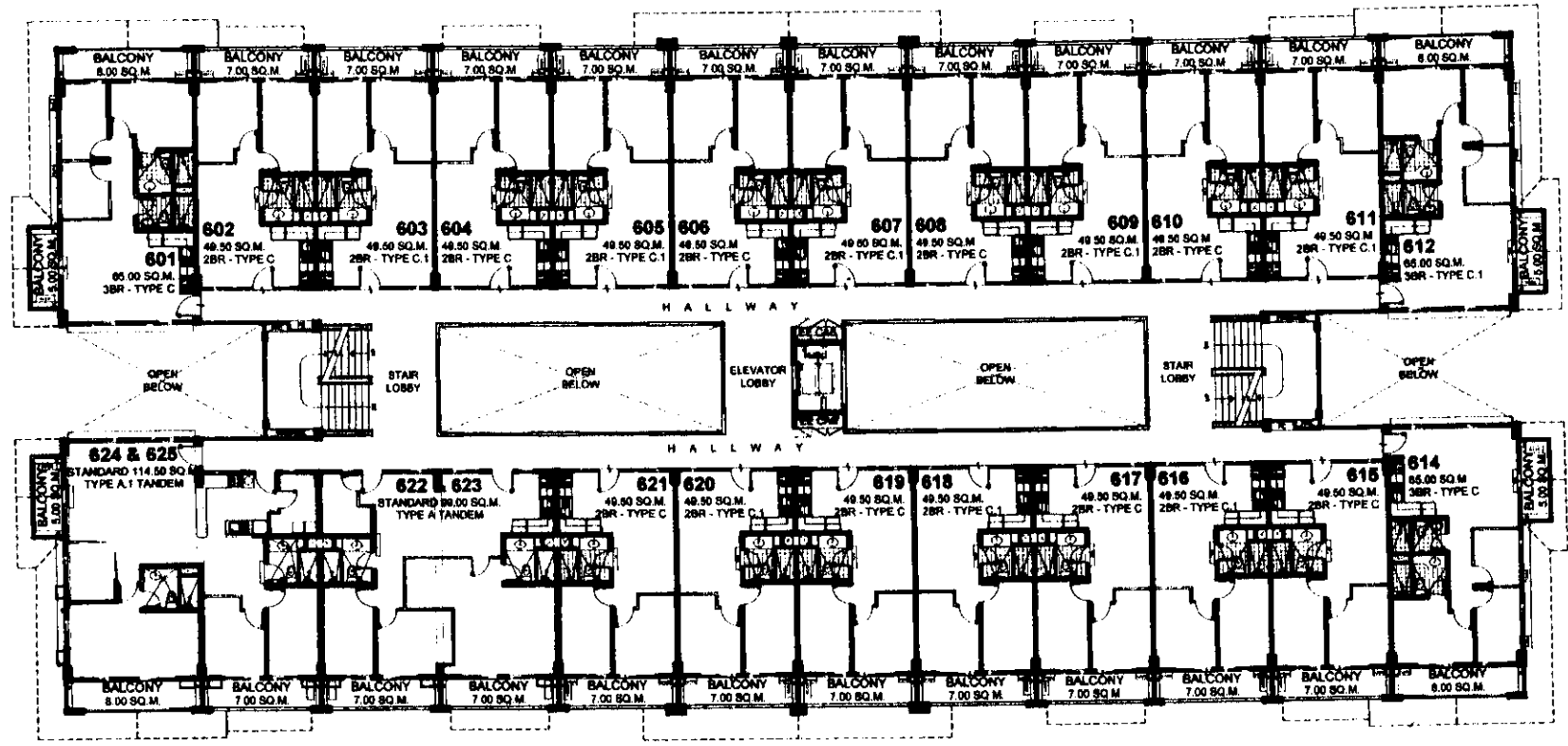

FACING AMENITIES

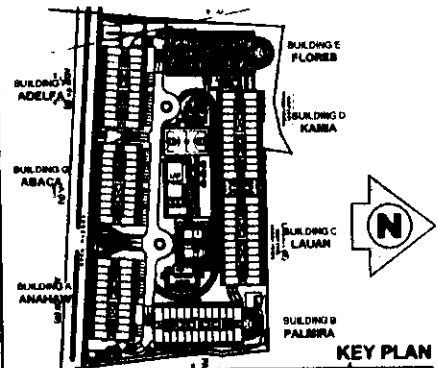

FLORES
SIXTH FLOOR PLAN
 OCTOBER 2018
 PER MEMO REF. DE-18-10-008

LIST FOR MANDATORY TANDEM UNITS:

- 622 & 623
- 624 & 625

LIST FOR POSSIBLE TANDEM UNITS:

- 603 & 604
- 605 & 606
- 607 & 608
- 609 & 610
- 616 & 617
- 618 & 619
- 620 & 621

NOTE:
 Standard company policy regarding request for tandem shall apply.

IVORY WOOD



| | | |
|----------|--------|-------------|
| NOTED BY | Franch | [Signature] |
| | RMS | [Signature] |
| | AMC | [Signature] |

Disclaimer: Floor plans depicted in this material are for demonstration purposes only and should not be relied upon as final project plans. For announcement purposes only.

AVAILABILITY PLAN

