

KAMIA
 LOWER LEVEL 2 FLOOR PLAN
 OCTOBER 2018
 PER MEMO REF. DE-18-10-008

NOTE:
 Standard company policy regarding request for tandem shall apply.

 IVORY WOOD

 DMCI HOMES <i>Feels real good to be home</i>	NOTED BY:	Francis	08-5
		RMS	1707
		AMC	1011

Disclaimer: Floor plans depicted in this material are for demonstration purposes only and should not be relied upon as final project plans. For announcement purposes only.

AVAILABILITY PLAN

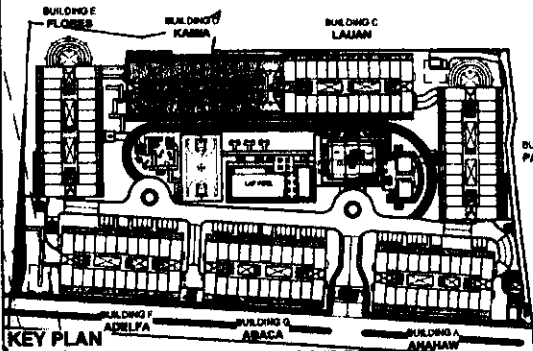
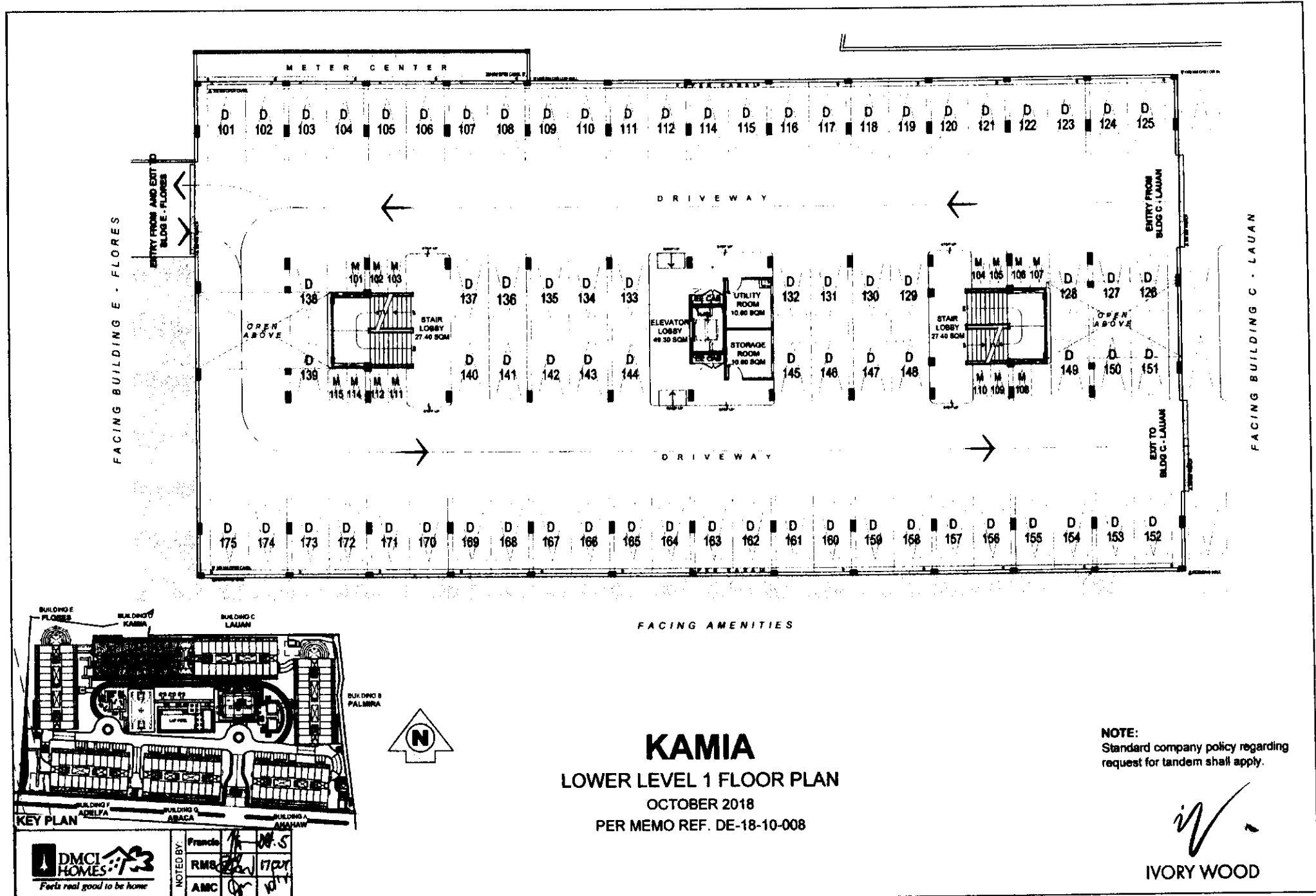

KAMIA
LOWER LEVEL 1 FLOOR PLAN
 OCTOBER 2018
 PER MEMO REF. DE-18-10-008

NOTE:
 Standard company policy regarding request for tandem shall apply.

IVORY WOOD



NOTED BY:	Francis	10/5
	RMS	17/01
	AMC	10/11

Disclaimer: Floor plans depicted in this material are for demonstration purposes only and should not be relied upon as final project plans. For announcement purposes only.

AVAILABILITY PLAN

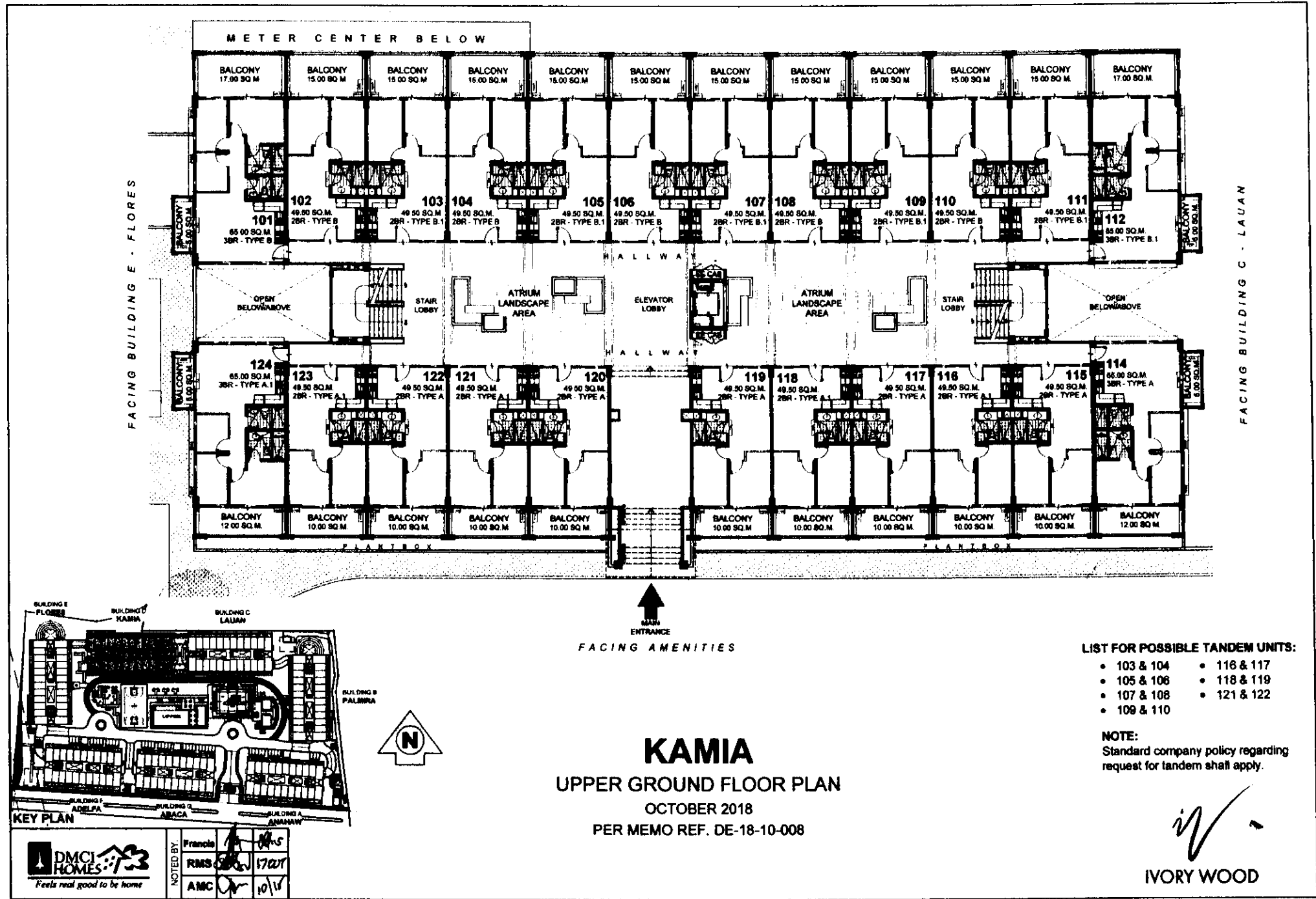

KAMIA
 UPPER GROUND FLOOR PLAN
 OCTOBER 2018
 PER MEMO REF. DE-18-10-008

- LIST FOR POSSIBLE TANDEM UNITS:**
- 103 & 104
 - 105 & 108
 - 107 & 108
 - 109 & 110
 - 116 & 117
 - 118 & 119
 - 121 & 122

NOTE:
 Standard company policy regarding request for tandem shall apply.

iv
 IVORY WOOD

AVAILABILITY PLAN

KEY PLAN

NOTED BY:	Francis	MS
	RMS	17/2/17
	AMC	10/1/17

Disclaimer: Floor plans depicted in this material are for demonstration purposes only and should not be relied upon as final project plans. For announcement purposes only.

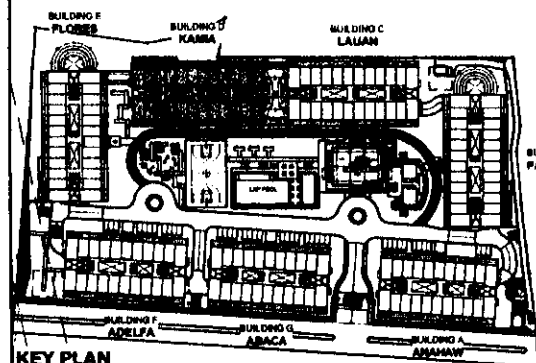
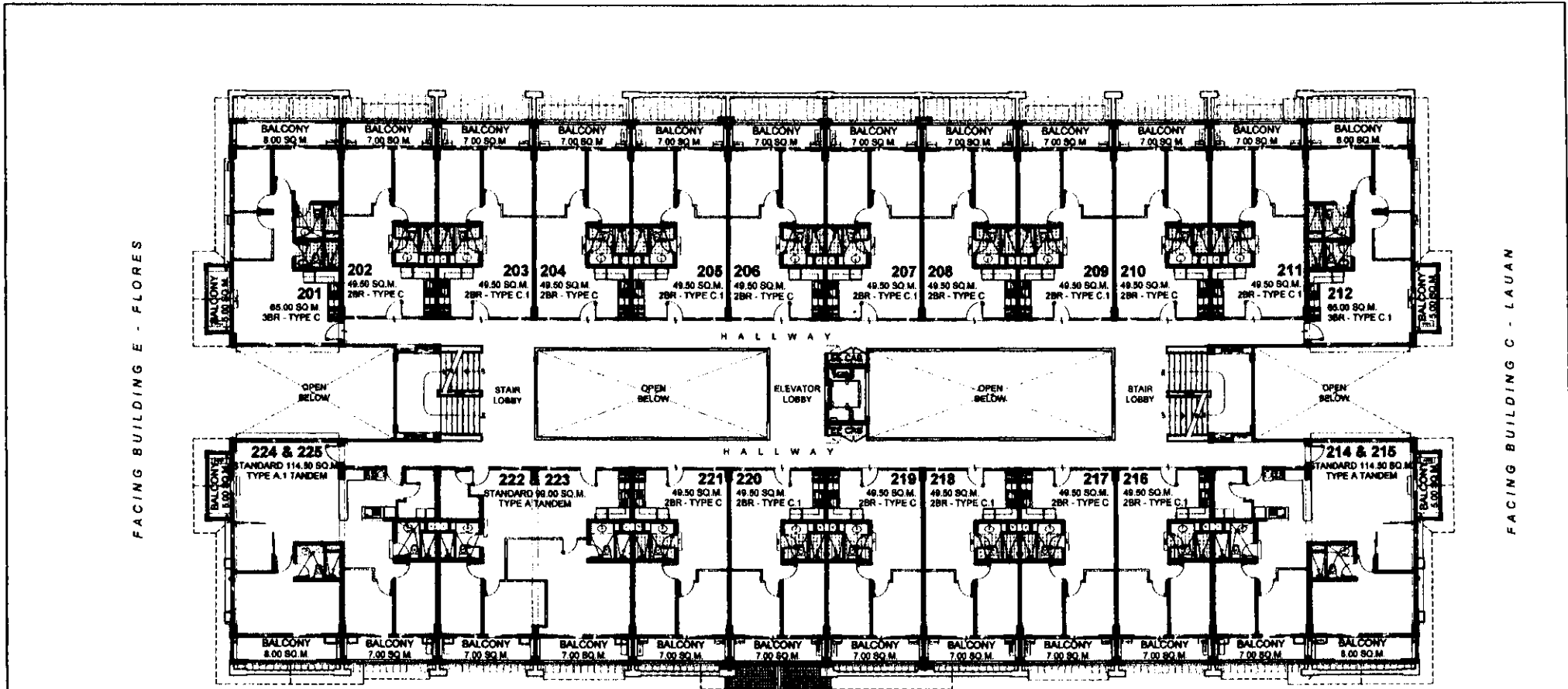

FACING AMENITIES

LIST FOR MANDATORY TANDEM UNITS:

- 214 & 215
- 224 & 225
- 222 & 223

LIST FOR POSSIBLE TANDEM UNITS:

- 203 & 204
- 216 & 217
- 205 & 206
- 218 & 219
- 207 & 208
- 220 & 221
- 209 & 210

NOTE:
Standard company policy regarding request for tandem shall apply.

KAMIA
SECOND FLOOR PLAN
OCTOBER 2018
PER MEMO REF. DE-18-10-008

	NOTED BY:	Francis	10/15
		RMS	10/17/18
		AMC	10/18

iv
IVORY WOOD

Disclaimer: Floor plans depicted in this material are for demonstration purposes only and should not be relied upon as final project plans. For announcement purposes only.

AVAILABILITY PLAN

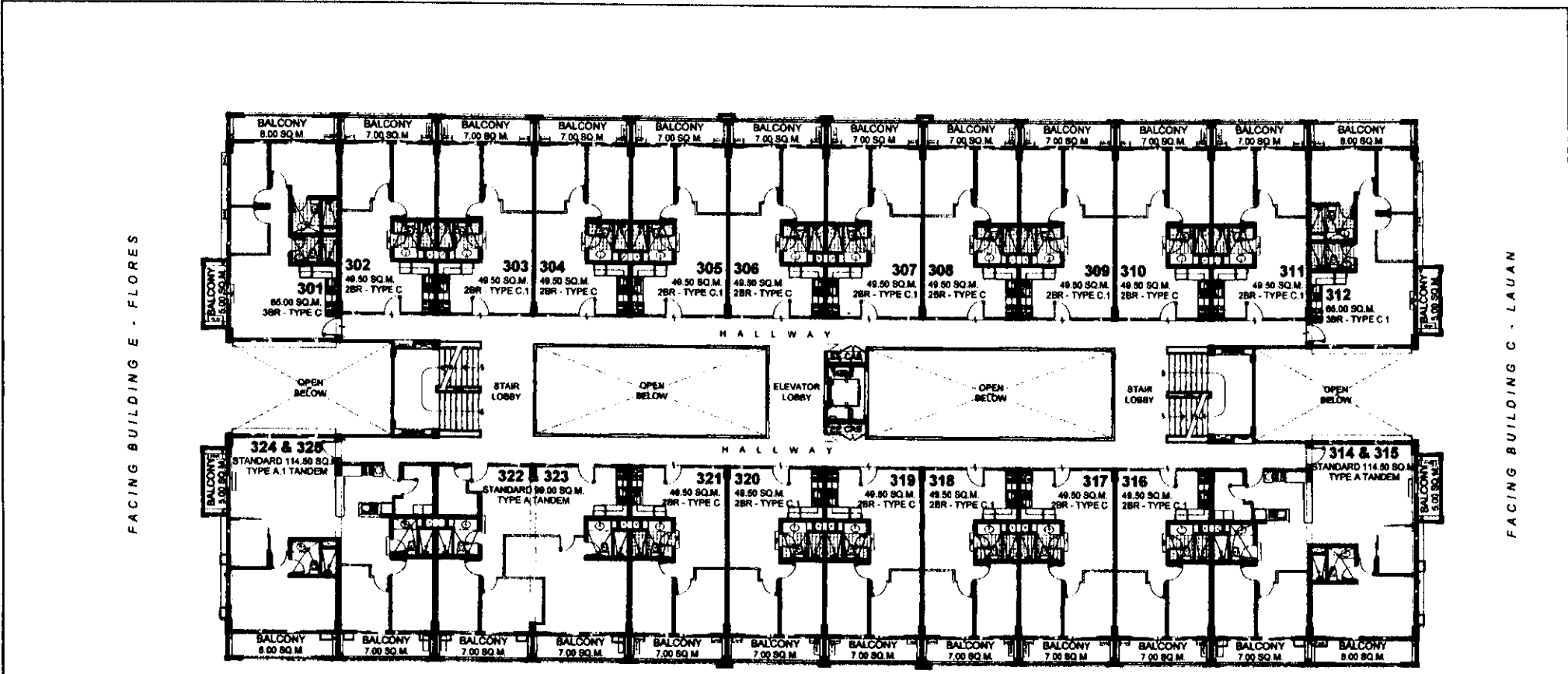

FACING BUILDING E - FLORES

FACING BUILDING C - LAUAN

FACING AMENITIES

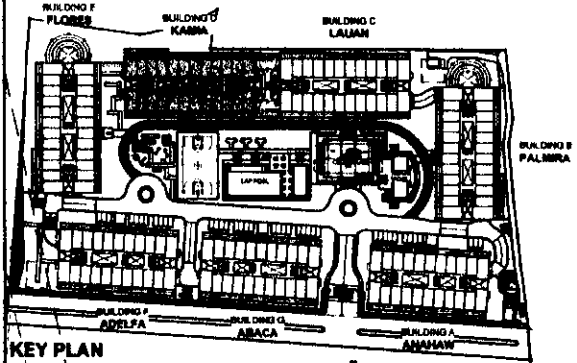

KEY PLAN



NOTED BY:	Francis	MS
	RMS	17/04
	AMC	10/11

KAMIA
 THIRD FLOOR PLAN
 OCTOBER 2018
 PER MEMO REF. DE-18-10-008

LIST FOR MANDATORY TANDEM UNITS:

- 314 & 215
- 324 & 325
- 322 & 223

LIST FOR POSSIBLE TANDEM UNITS:

- 303 & 304
- 316 & 317
- 305 & 306
- 318 & 319
- 307 & 308
- 320 & 321
- 309 & 310

NOTE:
 Standard company policy regarding request for tandem shall apply.

[Signature]
 IVORY WOOD

Disclaimer: Floor plans depicted in this material are for demonstration purposes only and should not be relied upon as final project plans. For announcement purposes only.

AVAILABILITY PLAN

FACING BUILDING E - FLORES

FACING BUILDING C - LAUAN

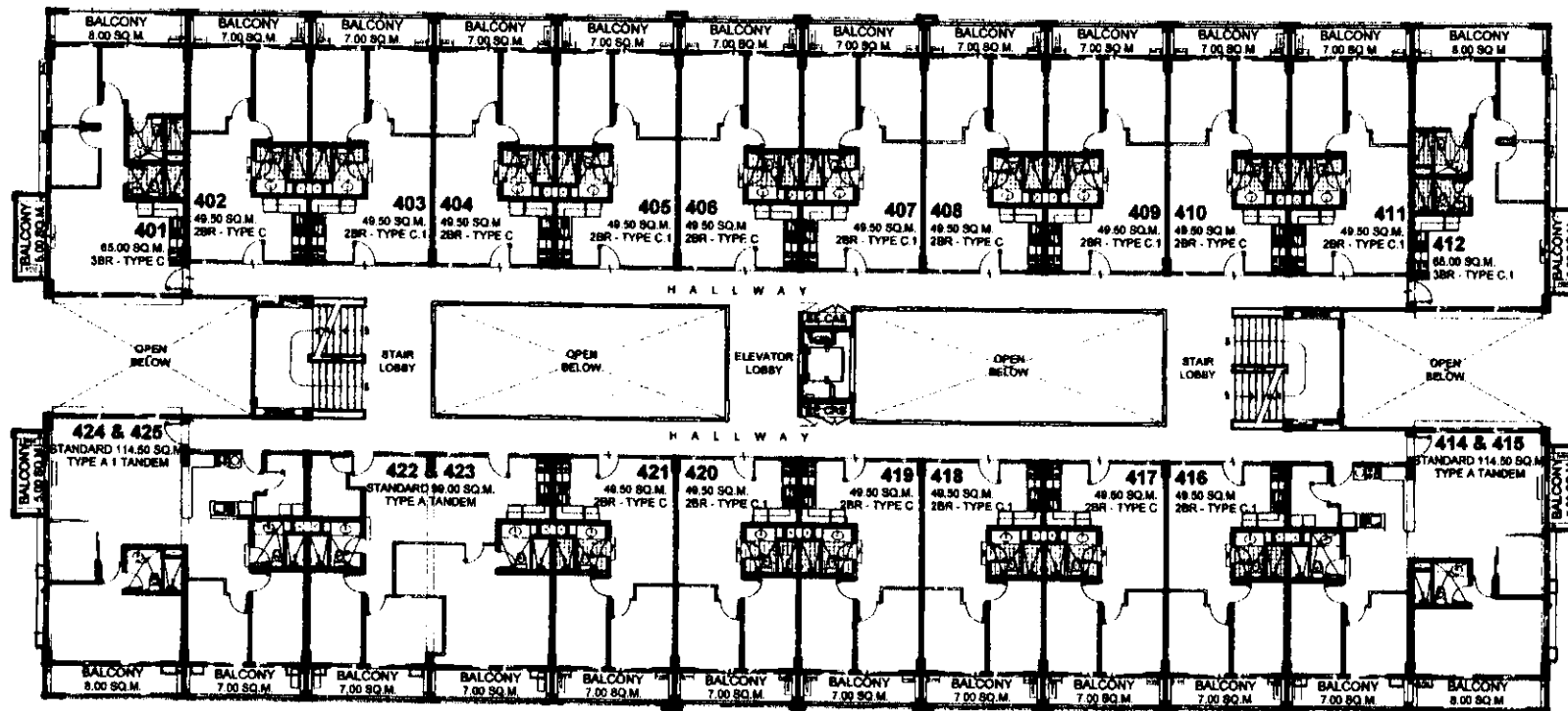

FACING AMENITIES

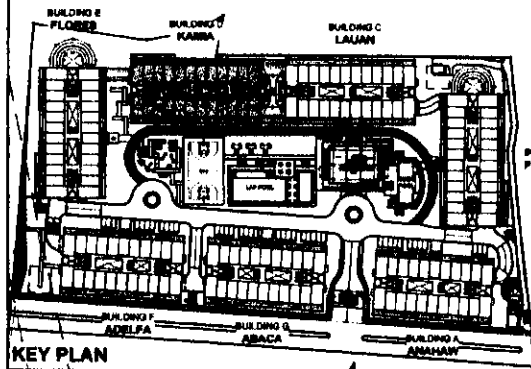

KAMIA
FOURTH FLOOR PLAN
 OCTOBER 2018
 PER MEMO REF. DE-18-10-008

LIST FOR MANDATORY TANDEM UNITS:

- 414 & 415
- 424 & 425
- 422 & 423

LIST FOR POSSIBLE TANDEM UNITS:

- 403 & 404
- 416 & 417
- 405 & 406
- 418 & 419
- 407 & 408
- 420 & 421
- 409 & 410

NOTE:
 Standard company policy regarding request for tandem shall apply.

IVORY WOOD

	NOTED BY:	Francie	10/5
		RMS	17/20/1
		AMC	01/1

Disclaimer: Floor plans depicted in this material are for demonstration purposes only and should not be relied upon as final project plans. For announcement purposes only.

AVAILABILITY PLAN

FACING BUILDING E - FLORES

FACING BUILDING C - LAUAN

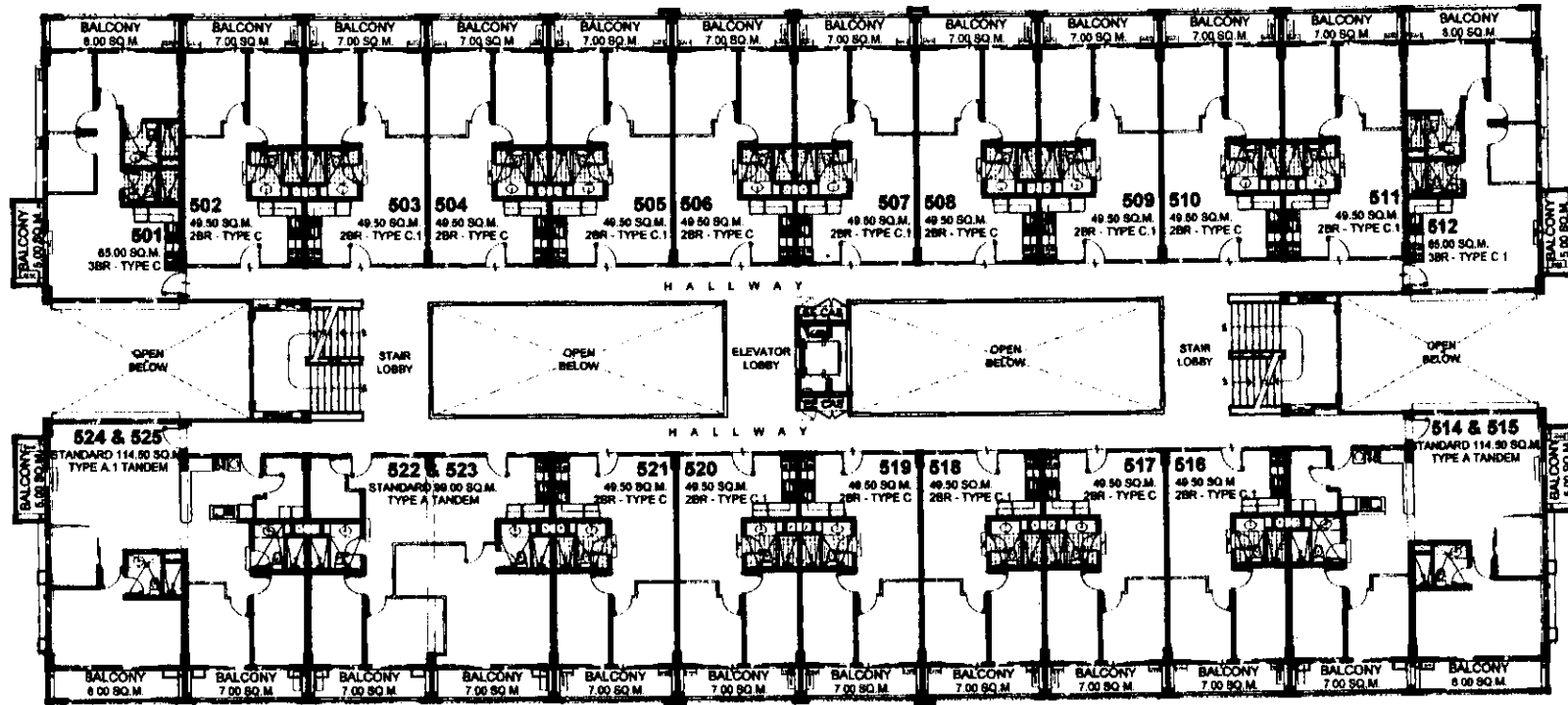

FACING AMENITIES

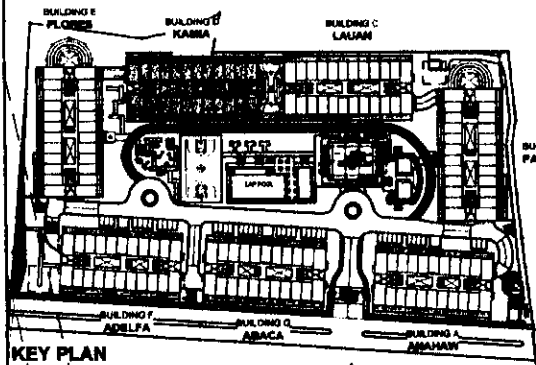

KEY PLAN



NOTED BY:	Francis	[Signature]
	RMS	[Signature]
	AMC	[Signature]

KAMIA
 FIFTH FLOOR PLAN
 OCTOBER 2018
 PER MEMO REF. DE-18-10-008

LIST FOR MANDATORY TANDEM UNITS:

- 514 & 515
- 524 & 525
- 522 & 523

LIST FOR POSSIBLE TANDEM UNITS:

- 503 & 504
- 518 & 517
- 505 & 506
- 518 & 519
- 507 & 508
- 520 & 521
- 509 & 510

NOTE:
 Standard company policy regarding request for tandem shall apply.

[Signature]
 IVORY WOOD

AVAILABILITY PLAN

Disclaimer: Floor plans depicted in this material are for demonstration purposes only and should not be relied upon as final project plans. For announcement purposes only.

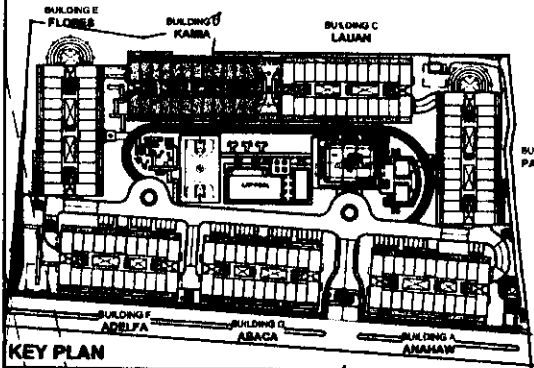
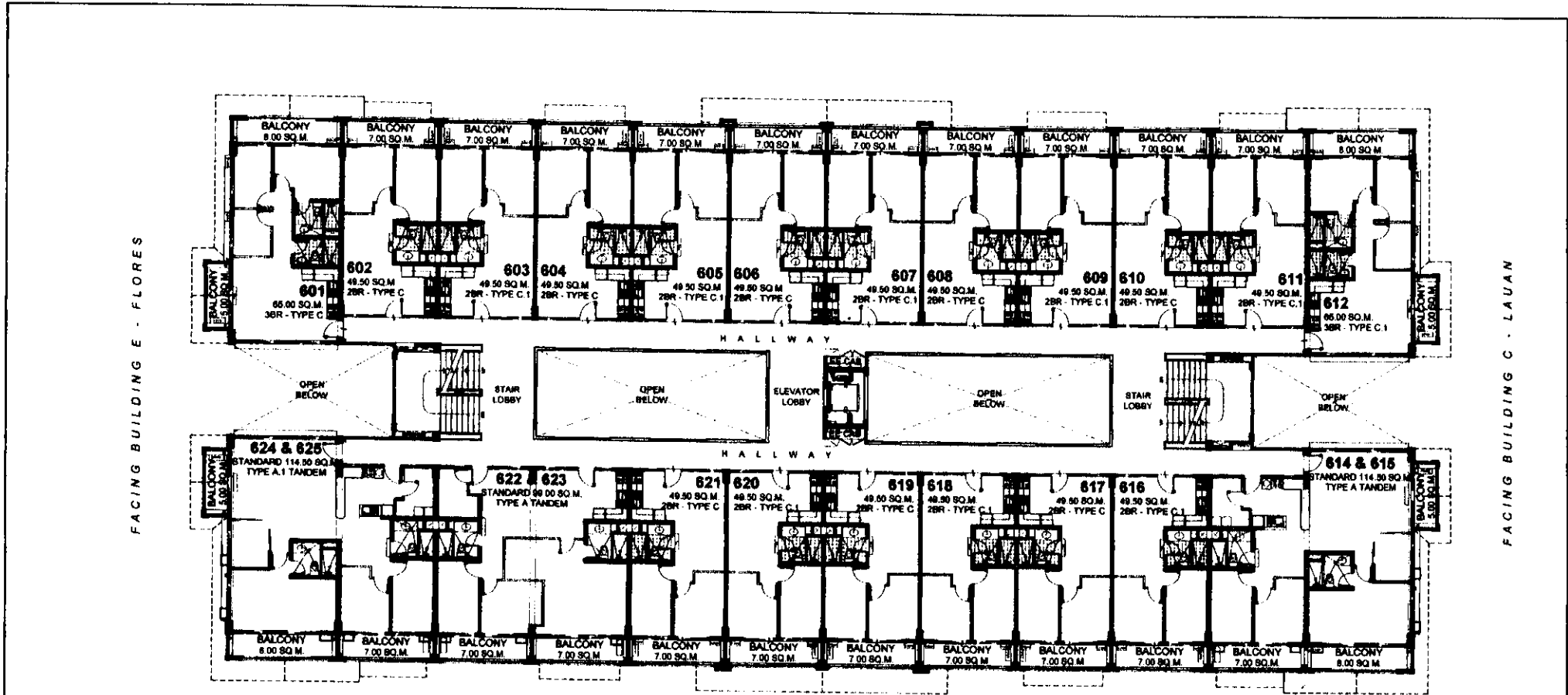

FACING AMENITIES

LIST FOR MANDATORY TANDEM UNITS:

- 614 & 615
- 624 & 625
- 622 & 623

LIST FOR POSSIBLE TANDEM UNITS:

- 603 & 604
- 616 & 617
- 605 & 606
- 618 & 619
- 607 & 608
- 620 & 621
- 609 & 610

NOTE:
Standard company policy regarding request for tandem shall apply.

KAMIA
SIXTH FLOOR PLAN
OCTOBER 2018
PER MEMO REF. DE-18-10-008

IVORY WOOD

AVAILABILITY PLAN

DMCI HOMES
Feels real good to be home.

NOTED BY:	Francis	10/15
	RMS	17/07
	AMC	10/11

Disclaimer: Floor plans depicted in this material are for demonstration purposes only and should not be relied upon as final project plans. For announcement purposes only.

FACING BUILDING E - FLORES

FACING BUILDING C - LAJUAN

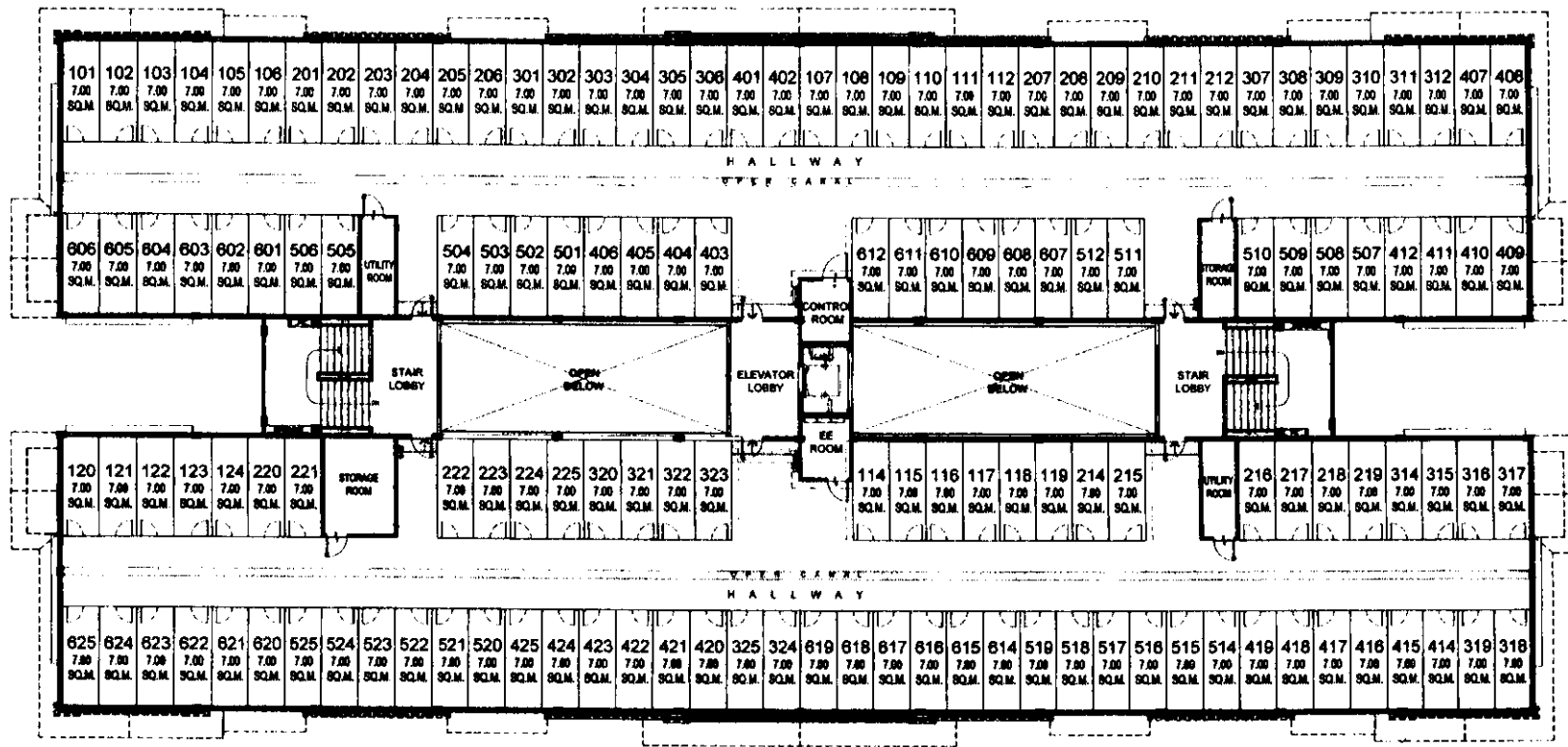

FACING AMENITIES

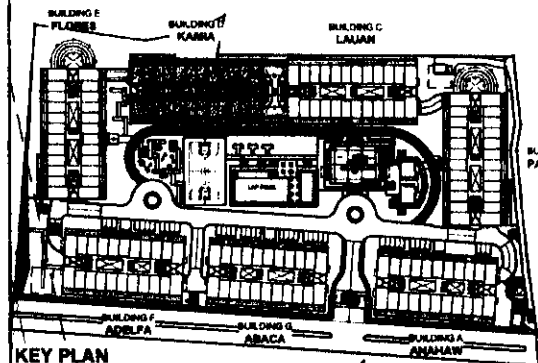

KAMIA

ROOFDECK FLOOR PLAN

OCTOBER 2018
PER MEMO REF. DE-18-10-008

NOTE:
Standard company policy regarding request for tandem shall apply.

[Signature]
IVORY WOOD

DMCI HOMES
Feels real good to be home

NOTED BY: Francis [Signature], RMS [Signature], AMC [Signature]

Disclaimer: Floor plans depicted in this material are for demonstration purposes only and should not be relied upon as final project plans. For announcement purposes only.

AVAILABILITY PLAN